

How to Hook Up a Residential Water Tap

Parts and Equipment



Regtrol XT Series Thermal Expansion Tanks

A pre-pressurized steel tank with an expansion membrane that prevents contact of the water with the air in the tank. This prevents loss of air to the water and insures long and trouble free life for the system. These tanks may be used with all types of Direct Fired Storage Tanks-gas, oil, or electric. Designed to absorb excessive pressure as "over 80 PSI". Used to prevent system or heater damage and unnecessary relief valve discharge from excessive pressure. Maximum temperature 210 F. Precharge 55 PSI. Connection 3/4 inch male.



Conbraco SERIES 4P-300 In-line Dual Check Valve or Industry Equipment



Conbraco Hose Connection Vacuum Breaker or Industry Equipment



Conbraco Series 36 Water Pressure Reducing Valve Industry Equipment

Diagram

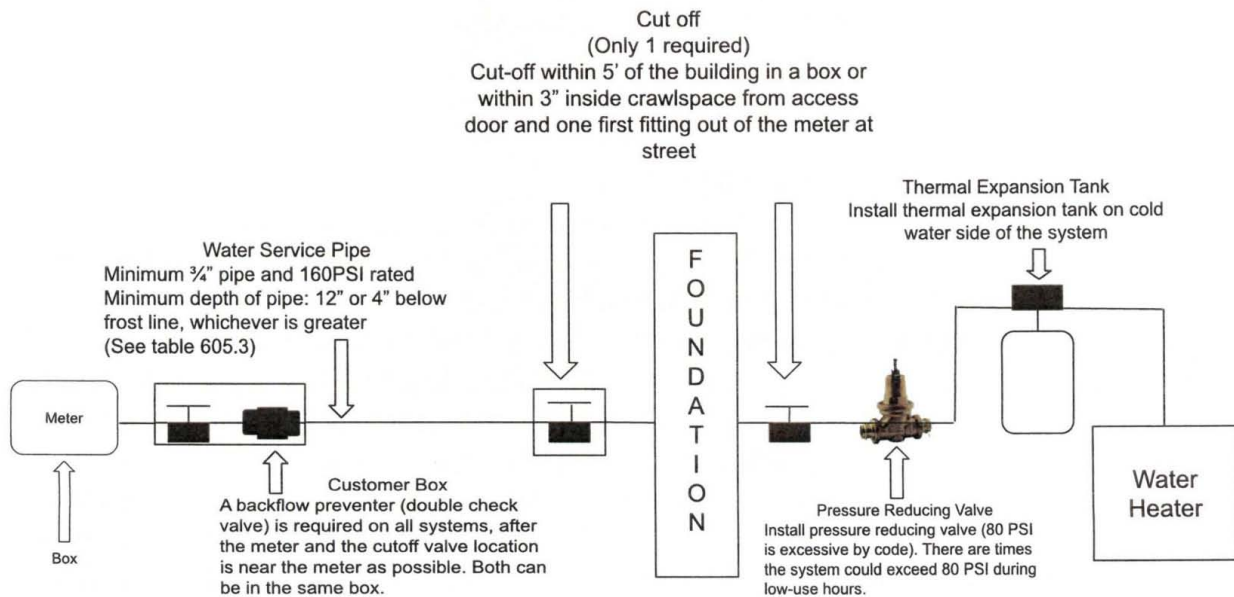

**TABLE P2906.4
WATER SERVICE PIPE**

MATERIAL	STANDARD
Acrylonitrile butadiene styrene (ABS) plastic pipe	ASTM D1527; ASTM D2282
Chlorinated polyvinyl chloride (CPVC) plastic pipe	ASTM D2846; ASTM F441; ASTM F442; CSA B137.6
Chlorinated polyvinyl chloride/aluminum/chlorinated polyvinyl chloride (CPVC/AL/CPVC) plastic pipe	ASTM F2855
Copper or copper-alloy pipe	ASTM B42; ASTM B43; ASTM B302
Copper or copper-alloy tubing (Type K, WK, L, WL, M or WM) ^a	ASTM B75; ASTM B88; ASTM B251; ASTM B447
Cross-linked polyethylene/aluminum/cross-linked polyethylene (PEX-AL-PEX) pipe	ASTM F1281; ASTM F2262; CSA B137.10
Cross-linked polyethylene/aluminum/high-density polyethylene (PEX-AL-HDPE) pipe	ASTM F1986
Cross-linked polyethylene (PEX) plastic pipe and tubing	ASTM F876; ASTM F877; AWWA C904; CSA B137.5
Ductile iron water pipe	AWWA C115/A21.15; AWWA C151/A21.51
Galvanized steel pipe	ASTM A53
Polyethylene/aluminum/polyethylene (PE-AL-PE) pipe	ASTM F1282; CSA B137.9
Polyethylene (PE) plastic pipe	ASTM D2104; ASTM D2239; AWWA C901; CSA B137.1
Polyethylene (PE) plastic tubing	ASTM D2737; AWWA C901; CSA B137.1
Polyethylene of raised temperature (PE-RT) plastic tubing	ASTM F2769
Polypropylene (PP) plastic tubing	ASTM F2389; CSA B137.11
Polyvinyl chloride (PVC) plastic pipe	ASTM D1785; ASTM D2241; ASTM D2672; CSA B137.3
Stainless steel (Type 304/304L) pipe	ASTM A312; ASTM A778
Stainless steel (Type 316/316L) pipe	ASTM A312; ASTM A778

a. Below grade Type K, WK, L, WL.

**TABLE P2906.5
WATER DISTRIBUTION PIPE**

MATERIAL	STANDARD
Chlorinated polyvinyl chloride (CPVC) plastic pipe and tubing	ASTM D2846; ASTM F441; ASTM F442; CSA B137.6
Chlorinated polyvinyl chloride/aluminum/chlorinated polyvinyl chloride (CPVC/AL/CPVC) plastic pipe	ASTM F2855
Copper or copper-alloy pipe	ASTM B42; ASTM B43; ASTM B302
Copper or copper-alloy tubing (Type K, WK, L, WL, M or WM) ^a	ASTM B75; ASTM B88; ASTM B251; ASTM B447
Cross-linked polyethylene (PEX) plastic tubing	ASTM F876; ASTM F877; CSA B137.5
Cross-linked polyethylene/aluminum/cross-linked polyethylene (PEX-AL-PEX) pipe	ASTM F1281; ASTM F2262; CSA B137.10
Cross-linked polyethylene/aluminum/high-density polyethylene (PEX-AL-HDPE) pipe	ASTM F1986
Galvanized steel pipe	ASTM A53
Polyethylene/aluminum/polyethylene (PE-AL-PE) composite pipe	ASTM F1282
Polyethylene of raised temperature (PE-RT) plastic tubing	ASTM F2769
Polypropylene (PP) plastic pipe or tubing	ASTM F2389; CSA B137.11
Stainless steel (Type 304/304L) pipe	ASTM A312; ASTM A778

a. Below grade Type K, WK, L, WL.

Page last updated on: May 11, 2026